

- 1 Concrete paving 50mm
- 2 Fixed height paving supports
- 3 RoofKrete Liquid Waterproofing
- 4 RoofKrete Geotextile membrane
- 5 Coping Stone by other
- 6 Parapet upstand/stone cladding by other
- 7 Proprietary parapet outlet - leaf guard to suit with extension pipe as required to suit parapet width - dimensions to be taken on site (90° downturn to hopper)
- 8 Hopper (by specialist subcontractor)
- 9 Concrete substrate

nb: Insulation by other tbc to achieve design U-value and comply with current Building Regulations

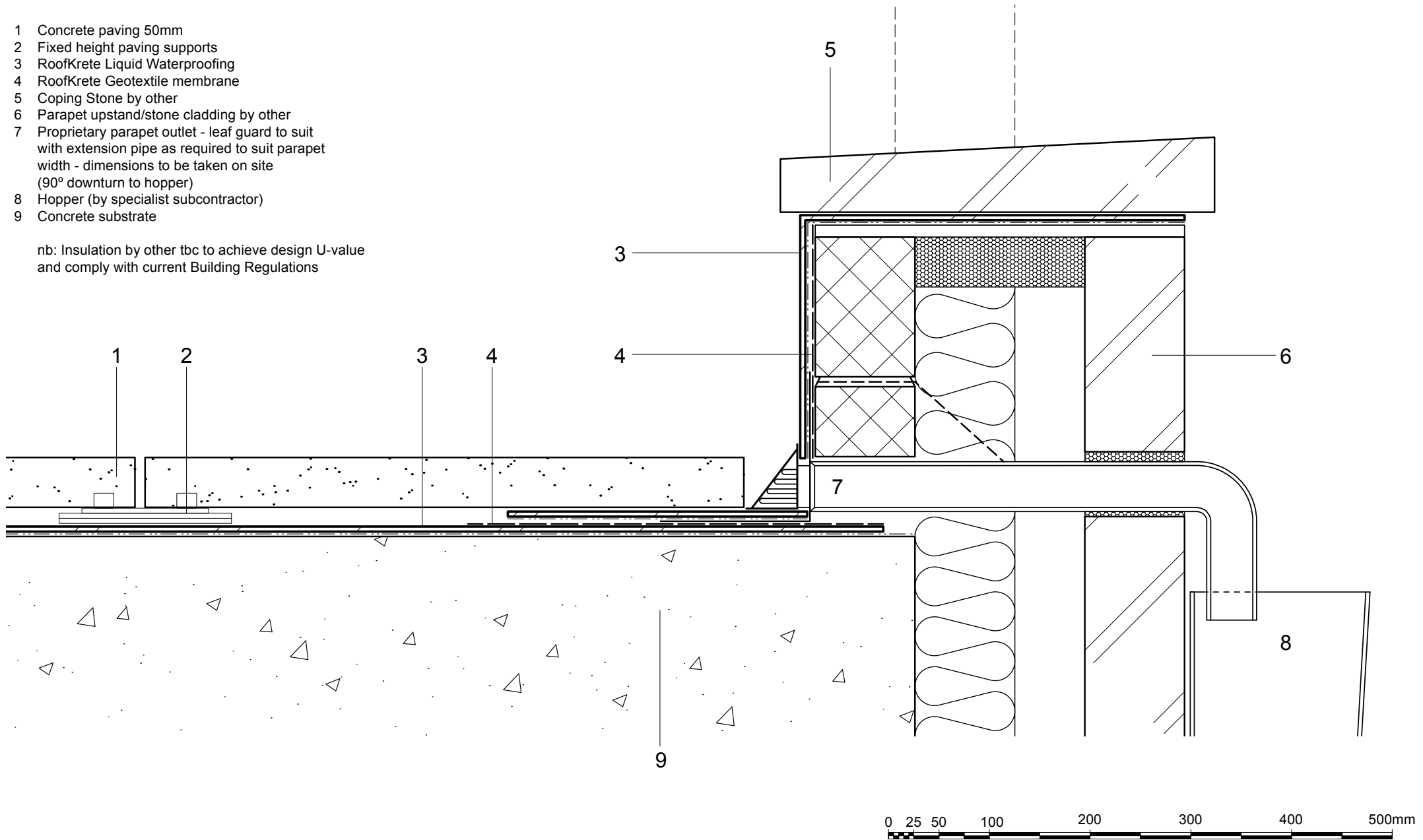

Do Not Scale This Drawing. All dimensions to be checked on site by Approved Installer

Roofkrete provide A4 detail drawings as part of our technical design service. This drawing should only be used as a guide during the design process and should not be utilised during construction. Roofkrete accepts no liability for misuse of this service.

DRAWING			PROJECT		
ROOFKRETE LIQUID WATERPROOFING TYPICAL PARAPET OUTLET DETAIL			HEBDEN TOWN HALL		
DWG.N°	SCALE	DATE	CLIENT		
KS4003.6A rev 02	1:5 @ A4	MARCH 2012	STRATEGIC TEAM GROUP		



Krete Sustain Systems Ltd
367 hale road, Hale Barns
Altrincham
Cheshire WA15 8TB
Tel: +44 79 7045 5050